

YM04, YM12 DISASSEMBLE CHART

- Disassembling Procedures Fig. ① → ⑤⑧
- Assembling Procedures Fig. ⑤⑧ → ①
- Parts code refer to parts list

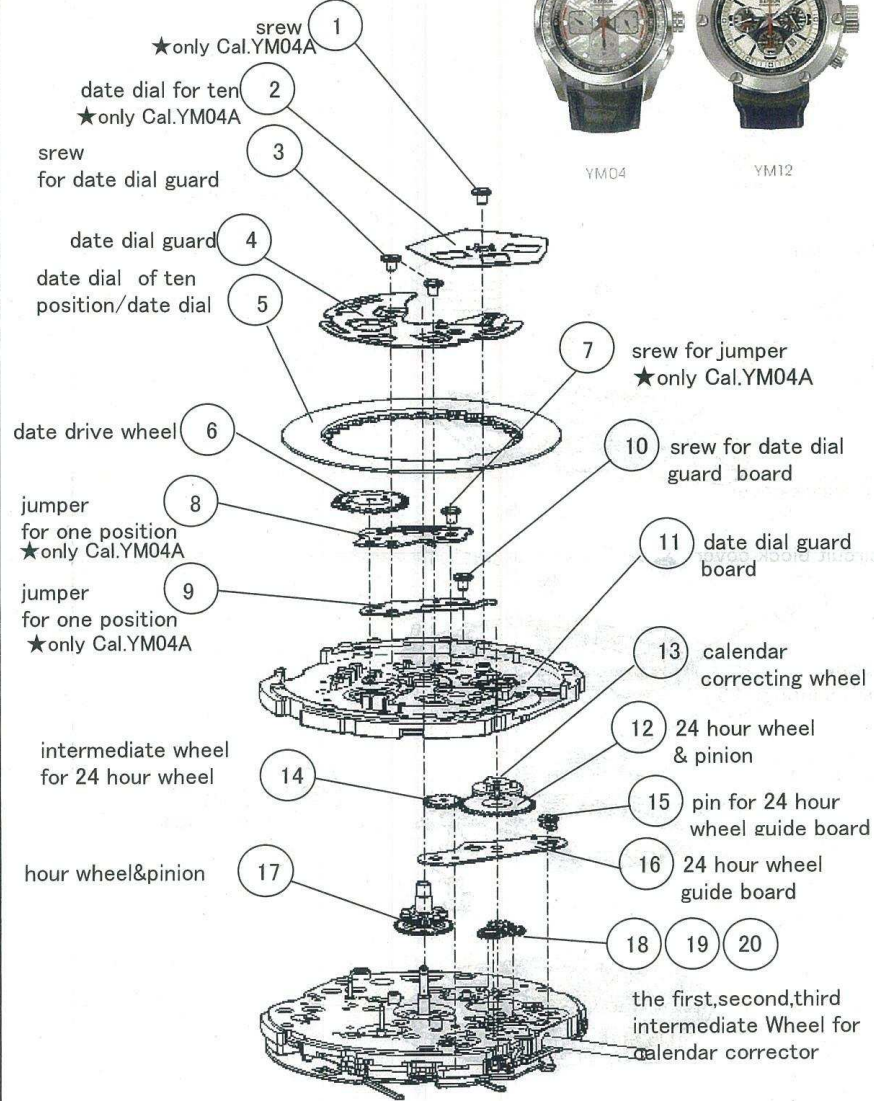

1) CALENDAR MECHANISM



2) CIRCUIT BLOCK AND BATTERY

TMI
TIME MODULE
S.EPSON PRODUCTS

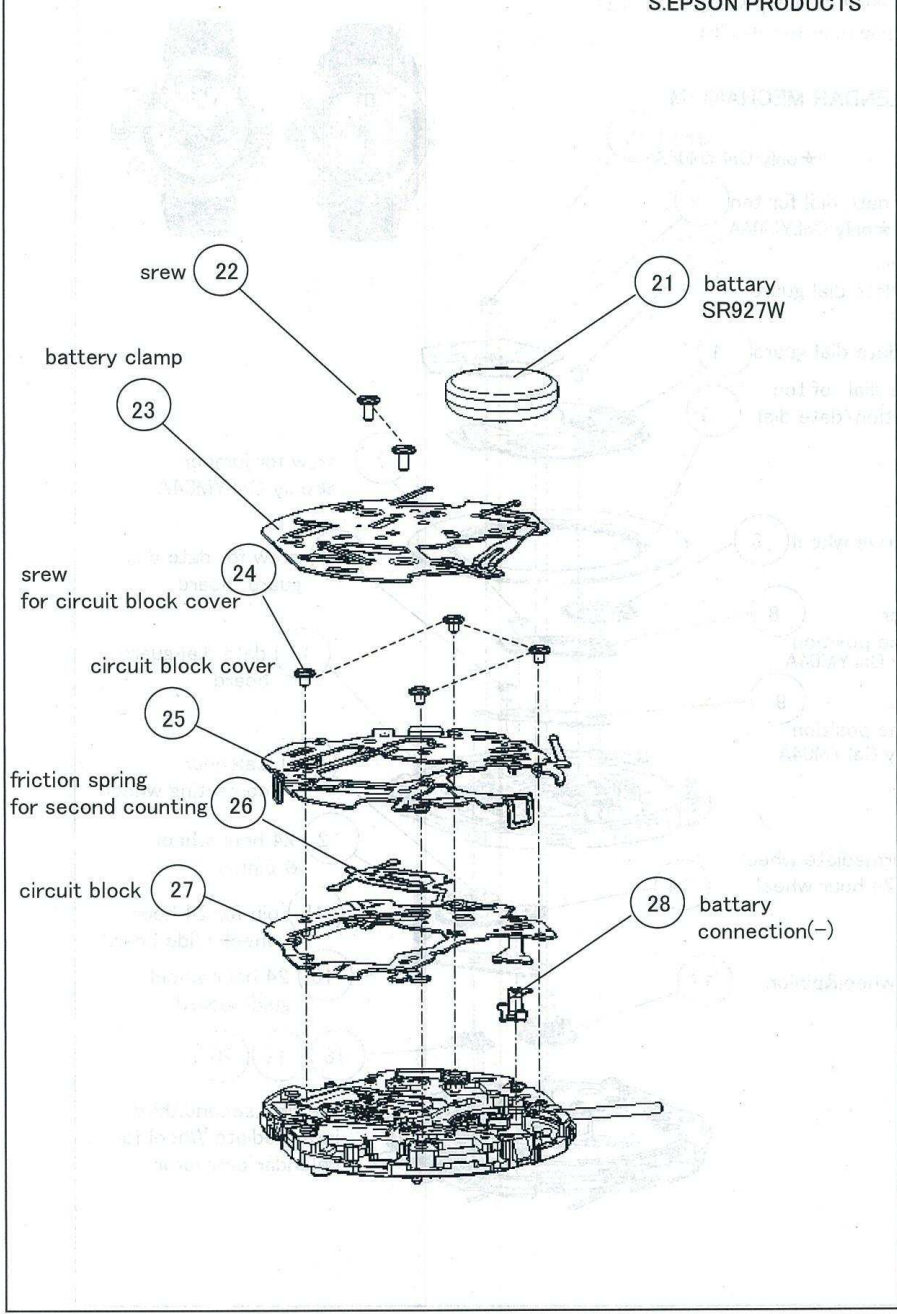

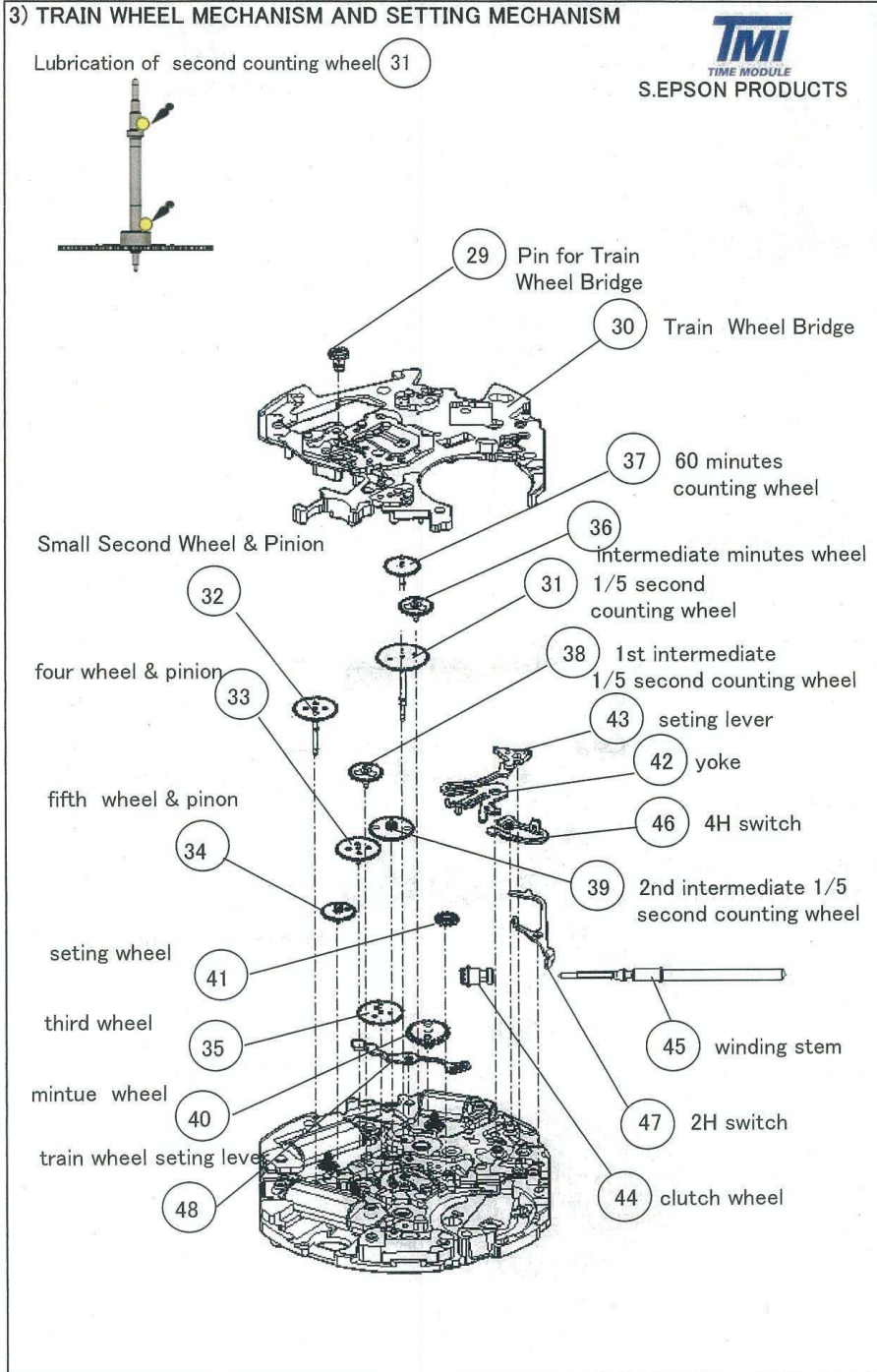

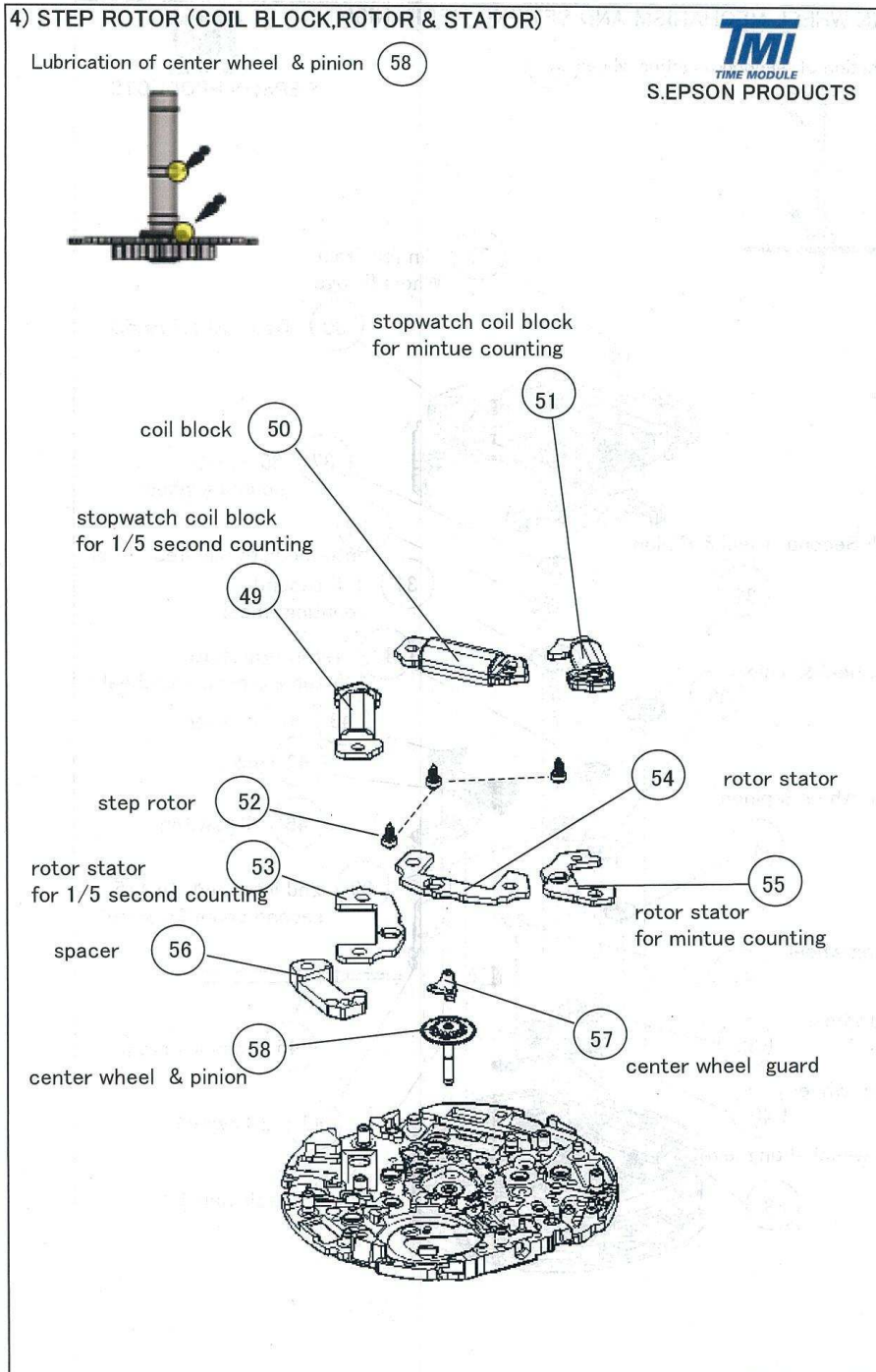

2.YM04 Attention To Assemble

Assembling position of date dial

There is a hole each other on the date dial of ten position, the date dial of one position and the date dial guide board. The calendar mechanism is able to work correctly Only the date dial of ten position and the date dial of one position are set on the correct position.

Please do reference of a figure

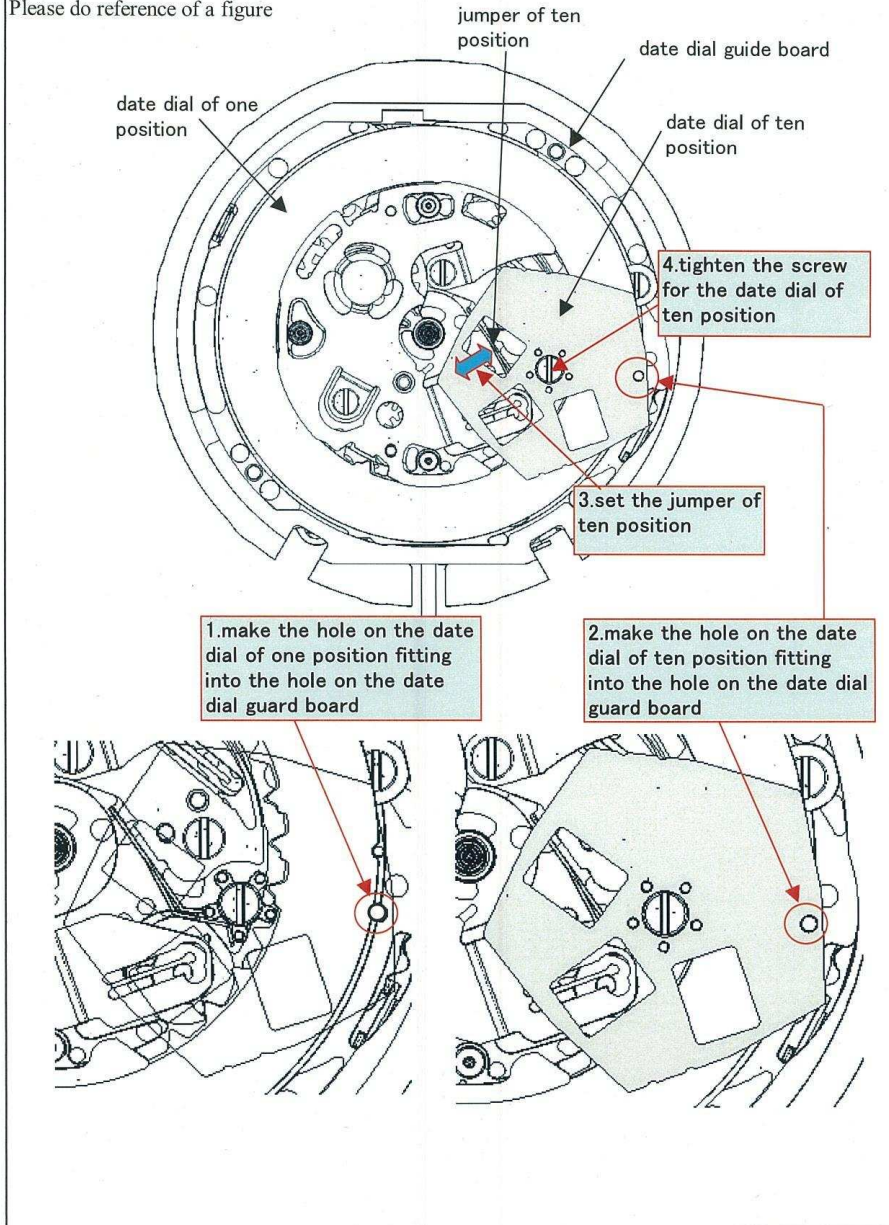

Parts List - Chronograph series 秒表·系列



| No. | PARTS NAME | CHINESE | Qty | YM04A | YM12A |
|-----|--|-----------|-----|----------|----------|
| 1 | Screw For Date Dial of Ten Position | 十位日曆盤螺絲 | 1 | 0012 354 | - |
| 2 | Date Dial of Ten Position(white) | 十位日曆盤(白) | 1 | 0878 B95 | - |
| 2 | Date Dial of Ten Position(black) | 十位日曆盤(黑) | 1 | 0878 B96 | - |
| 3 | Screw For Date Dial Guard | 日曆盤固定片螺絲 | 2 | 0012 354 | - |
| 4 | Date Dial Guard | 日曆盤固定片 | 2 | 0808 522 | 0808 523 |
| 5 | Date Dial(white) | 日曆盤 | 1 | - | 0878 B99 |
| 5 | Date Dial(Black) | 日曆盤 | 1 | - | 878 C01 |
| 5 | Date Dial of One Position(white) | 一位日曆盤(白) | 1 | 0878 B93 | - |
| 5 | Date Dial of One Position(black) | 一位日曆盤(黑) | 1 | 0878 B94 | - |
| 6 | Date Driving Wheel | 日曆推動輪 | 1 | 0802 515 | 0802 580 |
| 7 | Screw For Jumper | 日曆簧螺絲 | 1 | 0012 354 | - |
| 8 | Jumper for one position dial | 個位日曆簧 | 1 | 0810 504 | - |
| 9 | Jumper for Ten position dial | 十位日曆簧 | 1 | 0810 505 | - |
| 10 | Screw For Date Dial Guide Board | 日曆盤導向板螺絲 | 1 | 0012 354 | - |
| 11 | Date Dial Guide Board | 日曆盤導向板 | 1 | 0712 505 | 0712 506 |
| 12 | 24 Hour wheel | 24時輪 | 1 | 1002 534 | 1002 535 |
| 13 | Date Corrector Setting Wheel | 日期修正輪 | 1 | 0737 505 | - |
| 14 | 24 Hour Intermediate wheel | 24時過輪 | 1 | 0817 536 | - |
| 15 | Pin for 24 Hour Wheel Guide Board | 24時輪板固定片銷 | 1 | 0027 973 | - |
| 16 | 24 Hour Wheel Guide Board | 24輪固定片 | 1 | 4288 500 | - |
| 17 | Hour Wheel&pinion | 時輪 | 1 | 0271 636 | 0271 637 |
| 18 | First Intermediate Wheel for Calendar Corrector | 第一日曆過輪 | 1 | 0962 505 | 0962 580 |
| 19 | Second Intermediate Wheel for Calendar Corrector | 第二日曆過輪 | 1 | 0962 504 | - |
| 20 | Third Intermediate Wheel for Calendar Corrector | 第三日曆過輪 | 1 | 0962 504 | - |
| 21 | Battery | 電池 | 1 | SR927SW | - |
| 22 | Screw For Battery Clamp | 電池夾螺絲 | 2 | 0022 230 | - |
| 23 | Battery Clamp | 電池夾板 | 1 | 4225 576 | 4225 578 |
| 24 | Screw For Circuit Block Cover | 電路板蓋螺絲 | 4 | 0022 459 | - |
| 25 | Circuit Block Cover | 電路板蓋 | 1 | 4457 814 | - |
| 26 | Friction Spring for Second Counting | 計秒阻力簧 | 1 | 0396 580 | - |
| 27 | Circuit Block | 電路板 | 1 | 4000 727 | - |
| 28 | Battery Connection (-) | 負極片 | 1 | 4270 710 | - |
| 29 | Pin for Train Wheel Bridge | 伝動輪夾板固定銷 | 1 | 0027 974 | - |
| 30 | Train Wheel Bridge | 伝動輪夾板 | 1 | 0125 577 | - |
| 31 | 1/5 Second Counting wheel | 1/5秒計時輪 | 1 | 0888 501 | 0888 502 |
| 32 | Small Second Wheel & Pinion | 細秒針輪 | 1 | 0240 511 | 0240 512 |
| 33 | Fourth Wheel & Pinion | 4號輪 | 1 | 0241 583 | - |
| 34 | Fifth Wheel & Pinion | 5號輪 | 1 | 0701 581 | - |
| 35 | Third Wheel & Pinion | 3號輪 | 1 | 0231 580 | - |
| 36 | Intermediate Minutes counting wheel | 分計中間車 | 1 | 0950 590 | - |
| 37 | Minutes Counting Wheel | 分計時輪 | 1 | 0902 500 | 0902 501 |
| 38 | 1st Intermediate Wheel for 1/5 Second Counting | 1/5秒計一號過輪 | 1 | 0885 590 | - |
| 39 | 2nd Intermediate Wheel for Second Counting | 1/5秒計二號過輪 | 1 | 0885 591 | - |
| 40 | Minute Wheel & Pinion | 度數輪/分輪 | 1 | 0261 580 | - |
| 41 | Setting Wheel | 小鐵車/撥針輪 | 1 | 0281 580 | - |
| 42 | Yoke | 換日竿/橫擔 | 1 | 0384 582 | - |
| 43 | Setting Lever | 押掣竿 | 1 | 0383 592 | - |
| 44 | Clutch Wheel | 豬籠輪/離合輪 | 1 | 0282 585 | - |
| 45 | Winding Stem | 柄軸/巴心 | 1 | 0351 583 | - |
| 46 | Switch lever (B) | 4H按掣竿(B) | 1 | 4450 701 | - |
| 47 | Switch lever (A) | 2H按掣竿(A) | 1 | 4450 703 | - |
| 48 | Train Wheel Setting Lever | 輪組止動竿 | 1 | 0391 591 | - |
| 49 | Coil Block For 1/5 Second Counting | 1/5秒 計秒線圈 | 1 | 4002 700 | - |
| 50 | Coil Block | 線圈 | 1 | 4002 700 | - |
| 51 | Coil Block For Mintue Counting | 60分 計分線圈 | 1 | 4002 711 | - |
| 52 | Step Rotor | 轉子 | 3 | 4146 710 | - |
| 53 | Rotor Stator For 1/5 Second Counting | 1/5秒計定子 | 1 | 4239 717 | - |
| 54 | Rotor Stator | 轉子甲板/定子 | 1 | 4239 710 | - |
| 55 | Rotor Stator For Minute Counting | 分計定子 | 1 | 4239 712 | - |
| 56 | Spacer | 間隔片 | 1 | 0439 594 | - |
| 57 | Central Wheel Guard | 中心輪固定片 | 1 | 4283 581 | - |
| 58 | Central Wheel & Pinion | 中心輪 | 1 | 0221 604 | 0221 605 |