

2906A

1) Specifications

Casing diameter:	18.00mm
Height:	5.35 mm
Vibrations per hour:	28,800
Automatic winding (with hand winding mechanism)	
Calendar mechanism: Day & date, bilingual changeover system for the day of the week, instant day and date setting device	

2) Features

- *Thin automatic day and date lady's watch*
Having the technically excelled mechanism as with Cal. 2706 which has obtained a worldwide reputation for its high precision mechanism and variety of functions as a lady's watch, this watch offers a greater variety in design by making its movement slimmer than Cal. 2706.
- *Movement of highly stabilized time accuracy*
This movement is specially designed on the basis of the highly reliable movement mechanism of Cal. 61 series which have been marketed with a reputation on the overseas market.
- *Easy-to-use day/date setting device*
The day/date setting can be simply operated by turning the crown clockwise or counterclockwise after pulling out the crown in the 1st click position. At the same time, either of the two languages provided can be easily set to indicate the day of the week by the bilingual changeover system.
- *Simplified movement structure*
A sophisticated design of the watch movement has made it possible to reduce the number of parts and made it possible to adopt the new balance spring holding device. Thus, the simplified movement structure facilitates easy after-servicing.

3) Disassembling and reassembling

Disassembling procedures Figs.: ①~⑤⑤

Reassembling procedures Figs.: ⑤⑤~①

4) Lubricating

The following marks indicate the types of oil, quantities to be applied and lubricating portions.

Type of oil

- Moebius A
- Moebius V
- SEIKO Watch Oil S-6
- SEIKO Watch Oil S-3

Oil quantity

- Liberal quantity
- Normal quantity
- Extremely small quantity

Note: Never lubricate the portions marked ✕.

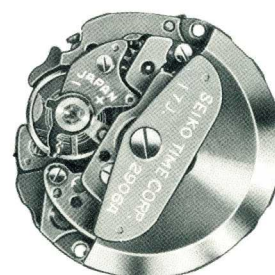

Movement

2906A Calendar mechanism

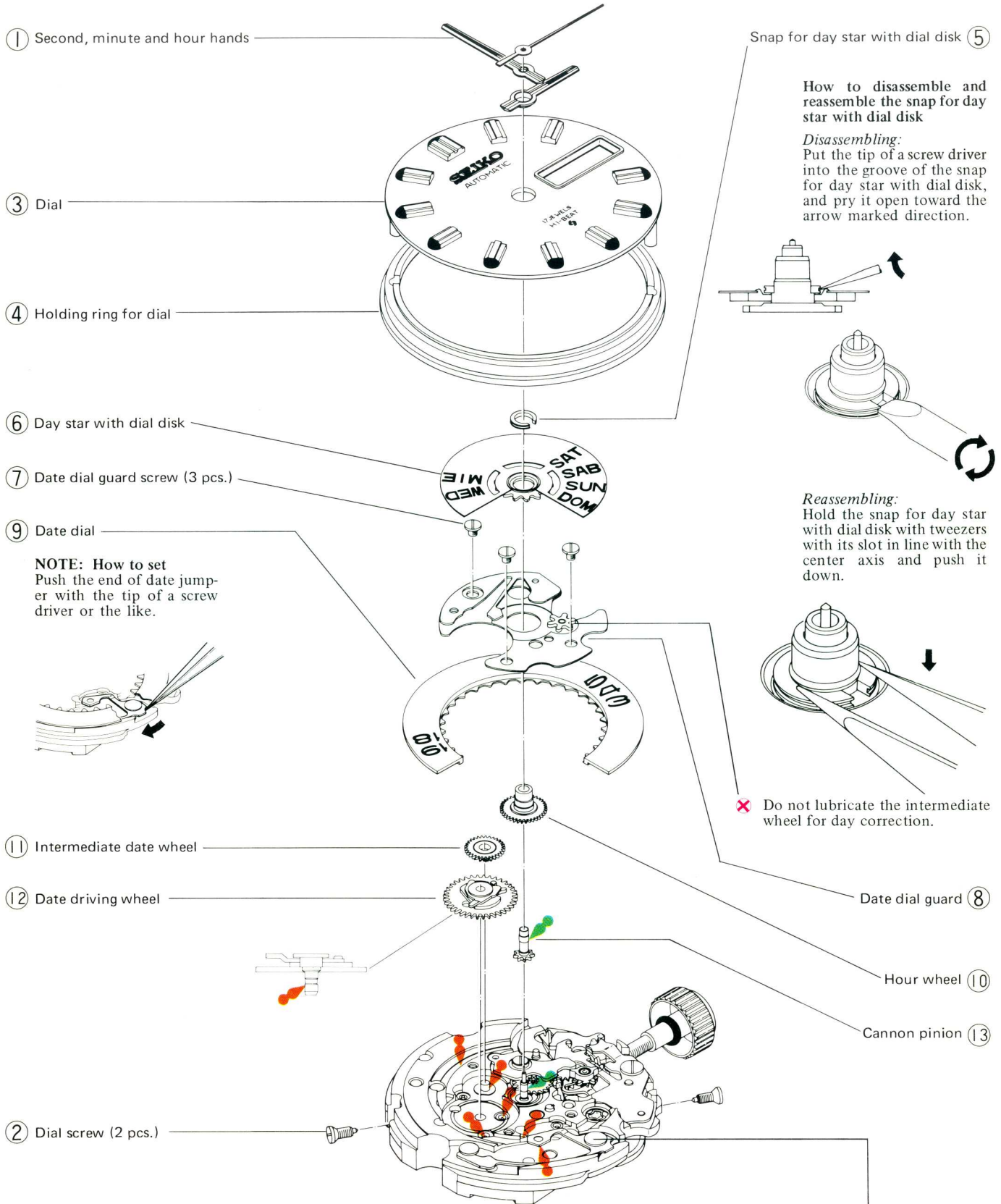

The date jumper cannot be removed as it is driven into the main plate.

2906A *Disassembling and reassembling of the balance spring holding device*

This device newly developed by SEIKO is very easy to fix the balance spring terminal. What is more, it always keeps the balance spring horizontally and facilitates repair-servicing.

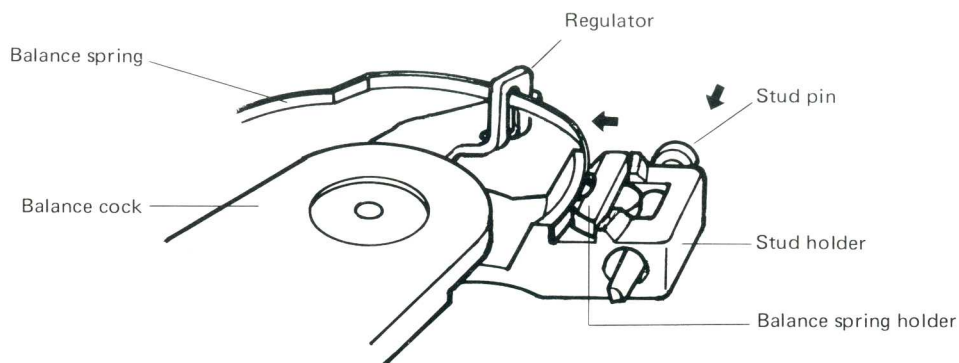

Remarks for disassembling

Push the end of the stud pin to remove. It is recommended to put the balance cock with balance in a polyethylene bag when disassembling, because the pin is liable to spring out.

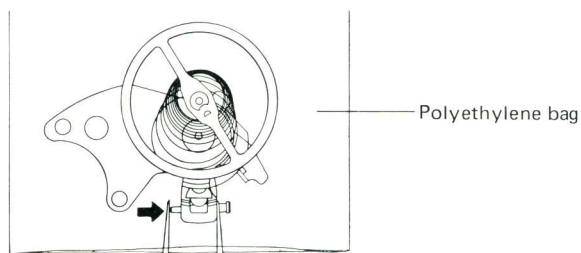

Remarks for reassembling

- (1) Place the outer end of the balance spring to the side of the stud holder as illustrated below, and secure the stud pin to push in firmly.

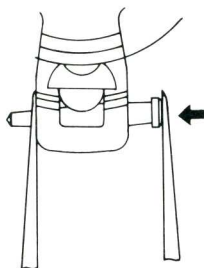

- (2) After setting the balance complete, adjust it so that the balance spring always touches not strongly the inner side of the regulator even when the balance is swinging with the mainspring fully wound.



2906A Automatic winding, escapement and governor mechanism

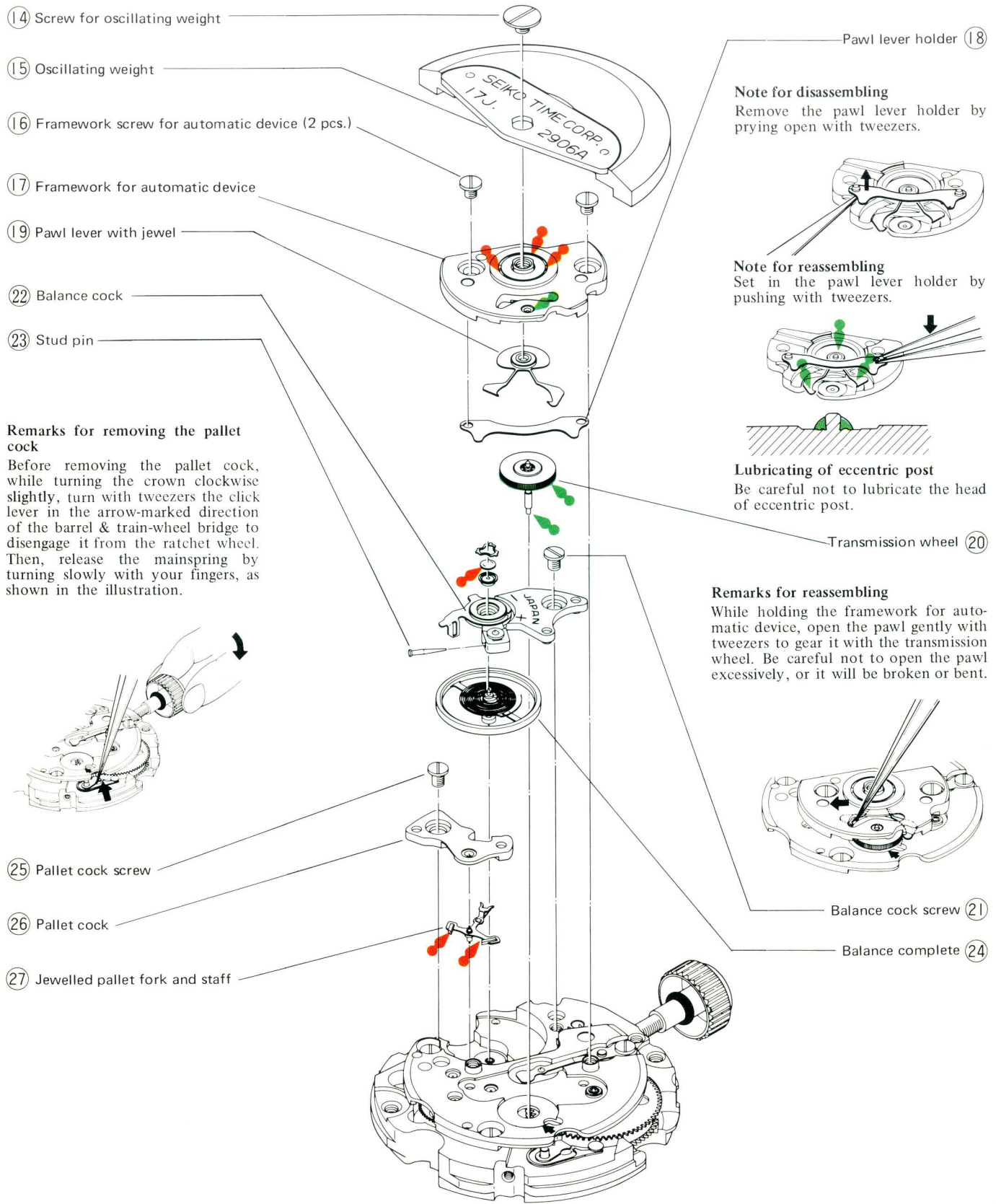

⑭ Screw for oscillating weight

⑮ Oscillating weight

⑯ Framework screw for automatic device (2 pcs.)

⑰ Framework for automatic device

⑲ Pawl lever with jewel

⑳ Balance cock

㉓ Stud pin

Remarks for removing the pallet cock

Before removing the pallet cock, while turning the crown clockwise slightly, turn with tweezers the click lever in the arrow-marked direction of the barrel & train-wheel bridge to disengage it from the ratchet wheel. Then, release the mainspring by turning slowly with your fingers, as shown in the illustration.

㉕ Pallet cock screw

㉖ Pallet cock

㉗ Jewelled pallet fork and staff

Pawl lever holder ⑱

Note for disassembling
Remove the pawl lever holder by prying open with tweezers.

Note for reassembling
Set in the pawl lever holder by pushing with tweezers.

Lubricating of eccentric post
Be careful not to lubricate the head of eccentric post.

Transmission wheel ㉒

Remarks for reassembling
While holding the framework for automatic device, open the pawl gently with tweezers to gear it with the transmission wheel. Be careful not to open the pawl excessively, or it will be broken or bent.

Balance cock screw ㉑

Balance complete ㉔

2906A Setting mechanism

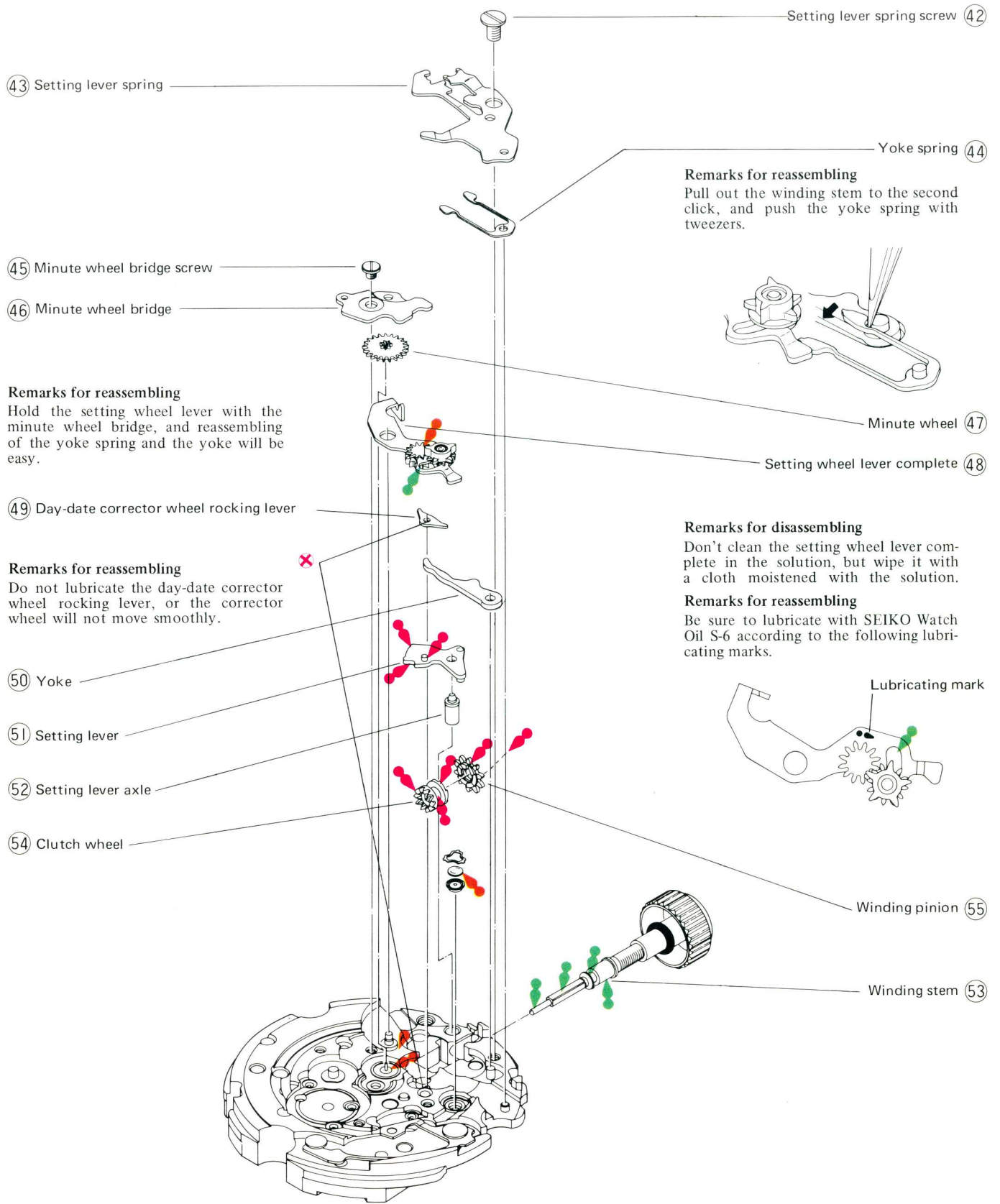

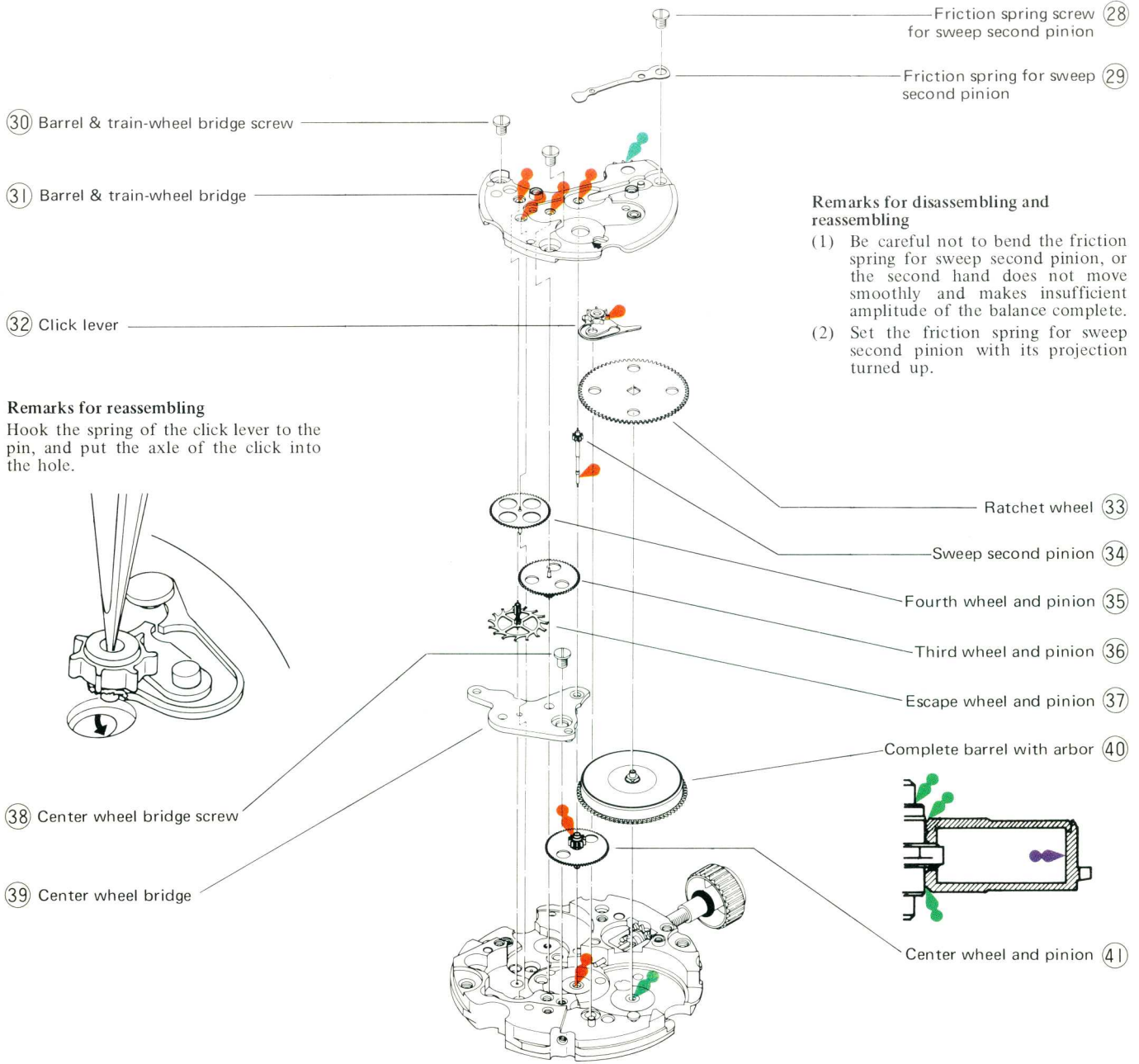

2906A Gear train mechanism



Function of click mechanism

The mainspring is wound through the processes as shown in the diagram. However, the mainspring will run down contrariwise when it is stopped to wind. In order not to run down the wound mainspring, the pawl lever prevents the transmission wheel from turning contrariwise.

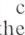
In case the automatic winding device is removed, the click wheel stops the ratchet wheel from turning contrariwise.

When the mainspring is unwound, remove the automatic winding device and push the concave of the click lever toward the arrow marked direction , and disengage the click wheel from the ratchet wheel toward the arrow-marked direction  as shown in the illustration.

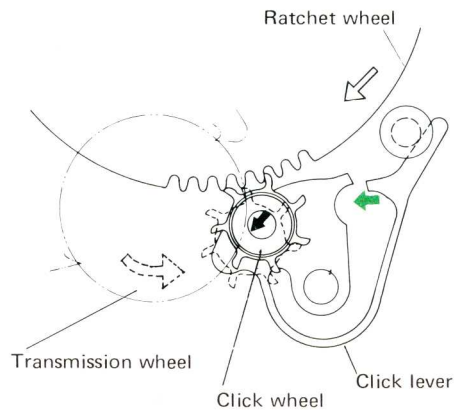

Winding process

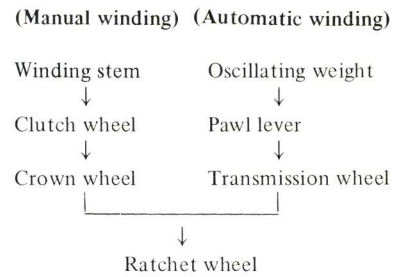

2906A *Calendar mechanism*

Crown at the normal position (for winding the mainspring)

The winding pinion and clutch wheel gear with each other. By turning the crown, the mainspring can be wound up.

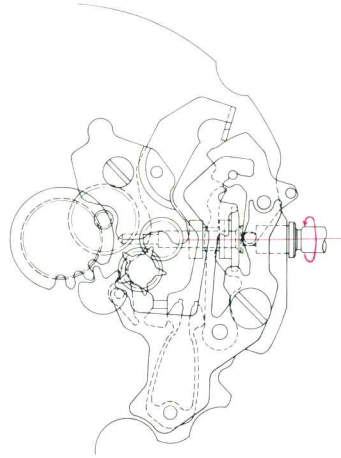

Crown at the first click position (for day/date setting)

The clutch wheel and the setting wheel gear with each other. Thus, rotation of the driving wheel for setting wheel is transmitted to the corrector wheel. At this position, when the crown is turned clockwise, the corrector wheel will move toward the date dial to correct the date. On the other hand, when the crown is turned counterclockwise the corrector wheel will move in the opposite direction to correct the day.

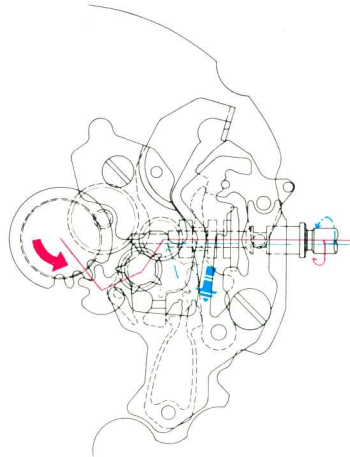

Crown at the second click position (for time setting)

When the setting wheel lever is pushed by the yoke spring, and the driving wheel for setting wheel gears with the minute wheel, the hands can be turned by turning the crown.

